

DS0270

NR HUB BLANK

This adapter is made from 8620 alloy steel and is designed to be customized to fit most motorcycle drive gears so our NR series sprockets can be used for racing. The 1.5" bore is for socket clearance when your engine has a nut to hold the gear on. When machining to fit your gear the total indicated runout after welding should be $\pm.002"$ or $.05\text{mm}$.

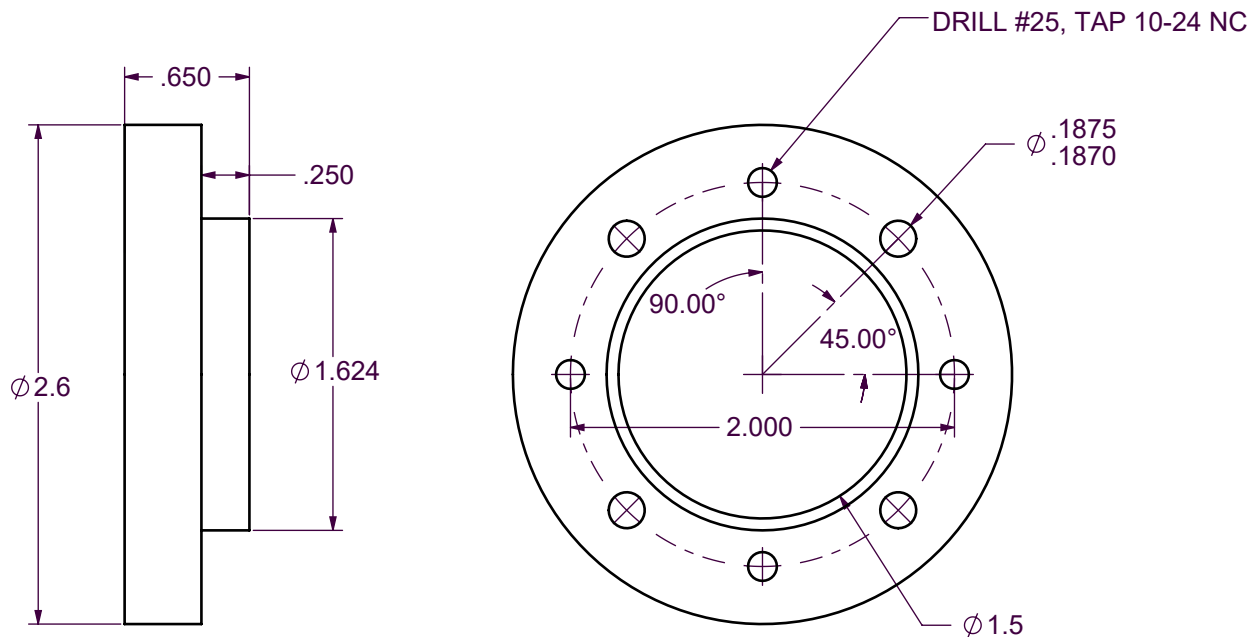

To weld this part to your existing drive gear both parts must be pre heated to a minimum of 200°F or 93°C . Parts should not exceed 800°F or 427°C . If possible use a high strength filler material compatible with 8620 steel. Allow the welded parts to cool slowly. Do not quench in oil or water if above 200°F or 93°C !

This product does not carry any warranty.

We will not be responsible for safety, chain life or performance.

Use at your own risk!